

 **VAHLE**

## BOK - System

Power & Data supply with load bearing beam

**SYSTEMS IN MOTION**

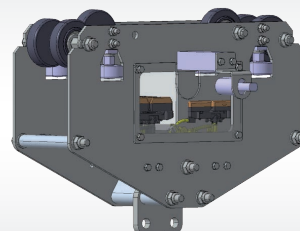
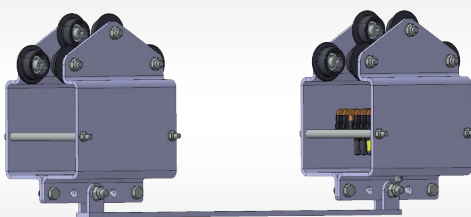
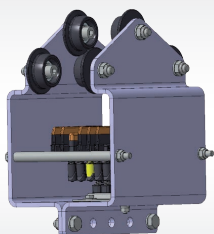

# Power, Data, Positioning, & Support - All in one

The compact BOK system has proven itself for many years in various applications such as assembly, testing, commissioning and battery charging . As a load bearing system, BOK is especially useful with production and assembly conveyors when hand tools or control monitors are required.

The BOK system is comprised of a low profile aluminum track (monorail) with specially designed compact hangers installed at the bottom flange of the track. These hangers are for the installation of VAHLE U 10 conductor bar as well as the APOS positioning system and a leaky data cable for data transmission requirements.

## Areas of application

- Screw fastener technology at production and assembly lines
- Commissioning sections
- Test installations at assembly lines
- Battery charging systems

Type	Load capacity	Track hanger support distance
Single carrier	70 lbs	max. 3 m
Double carrier	140 lbs	max. 3 m
Single carrier (heavy duty)	550 lbs	max. 2 m

**Please Note:** Additional information, including U10 and APOS technical data, can be found by visiting our website at [www.vahleinc.com](http://www.vahleinc.com) or contacting us directly.

With these components you can supply current, positioning and data transmission simultaneously. Support carriers are inserted into the aluminum track and manually positioned as required. Carriers can support loads of 70 lbs, 140 lbs or 550 lbs and can be equipped with structural racks to accept tools, instruments or monitors as required in order to create highly efficient, easily moveable workstations.

## System specifics

- Track profile typically installed above assembly line
- Electrical current supply along entire length of line
- Carriers available for up to 550 lbs load capacity
- Bi-directional operation

## Structural racks

Custom support racks to meet specific customer requirements.

- variable support rack in modular construction
- manufactured to customer requirements
- highly adaptable to accept tools and instruments
- expandable and able to retrofit

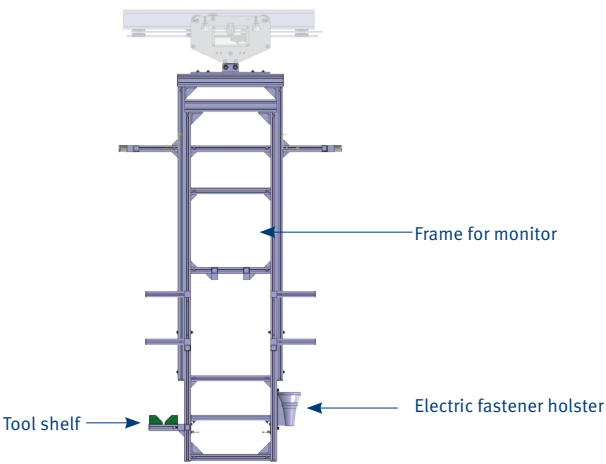
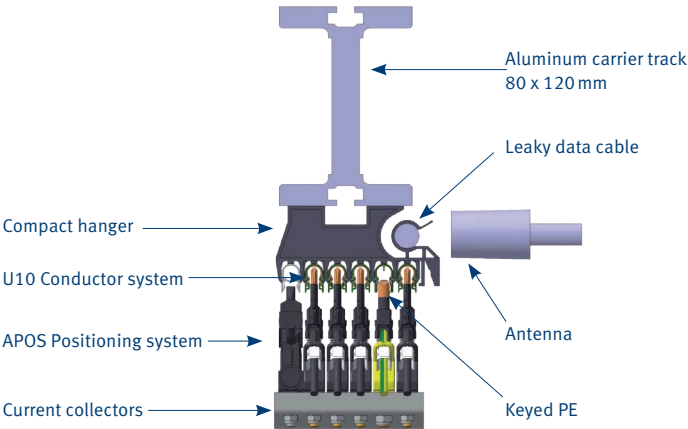

## BOK-System

The VAHLE BOK System is a custom supplied turn-key solution. The basic system consists of the aluminum track, U10 conductor bar, carriers and all support hardware. Optional extras include the APOS positioning System and a leaky data cable for data transmission.

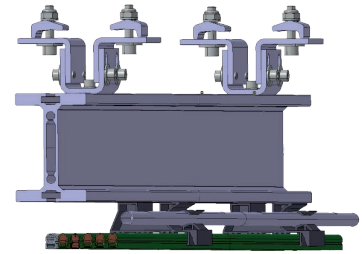

## Single Carrier

The standard single carrier is supplied in 2 versions: Basic or Complete. The complete version is required when the leaky data cable and antenna are supplied. Both versions support up to 6 pole collectors and our APOS positioning System. Max load capacity is 70 lbs.

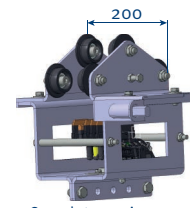

Complete carrier

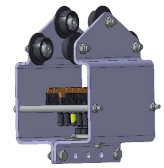

Basic carrier

## Double carrier

When additional load and support are required, VAHLE offers a double carrier. Similar to the single carrier, this may be supplied as either Basic or Complete. With the double carrier, max load capacity is 140 lbs.

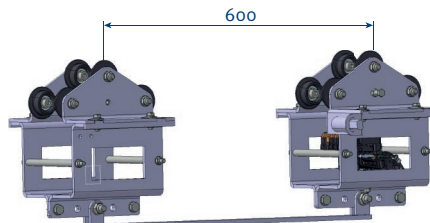

Complete carrier

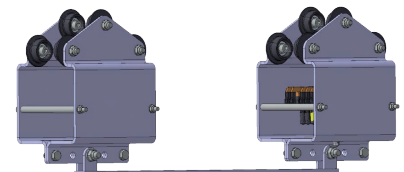

Basic carrier

## Single carrier (heavy duty)

In applications requiring high load capacity, VAHLE offers our Heavy Duty single carrier. Supporting up to 6 poles, APOS positioning System and Leaky data cable this carrier comes in a single variety. Max load capacity is 550lbs.

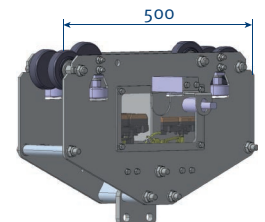

## Other Products and Services

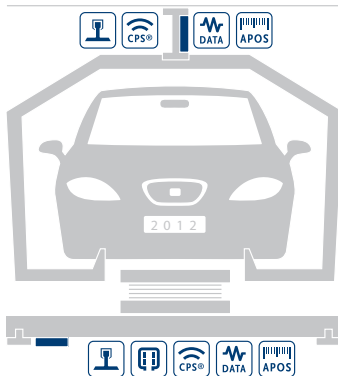

### Assembly Automation

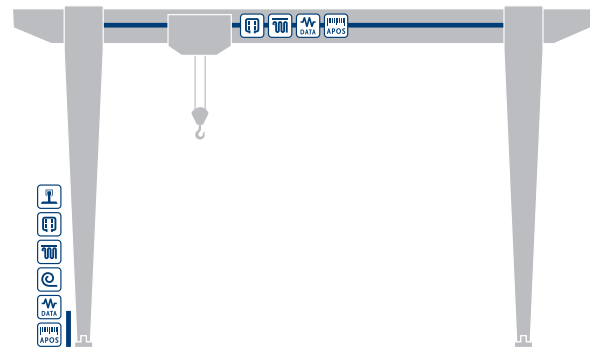

### Crane Technology

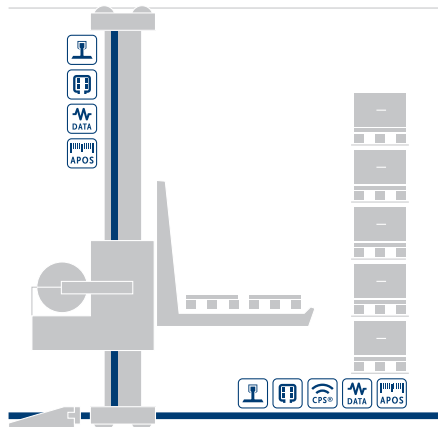

### Storage & Sorting

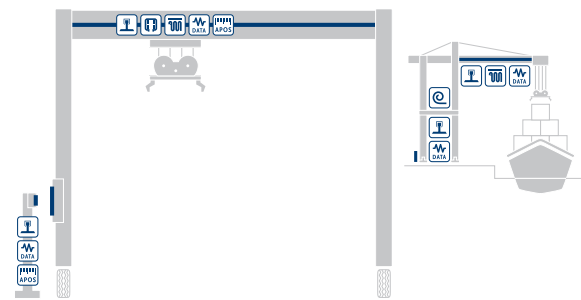

### Port Technology



### AGVs

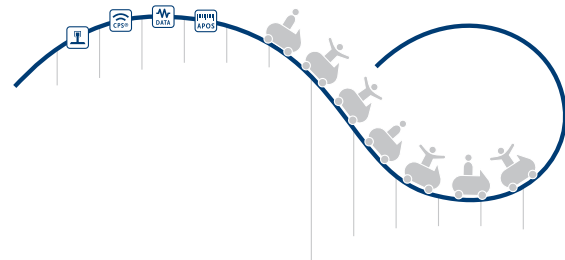

### Amusement



 DQS certified in accordance with DIN EN ISO 9001:2008  
 OHSAS 18001 (Reg.No. 003140 QM OH)

  
 ELECTRIFICATION SYSTEMS